

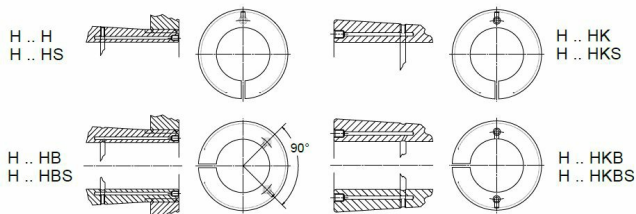

H 3036 HB

Adapter sleeves with metric dimensions

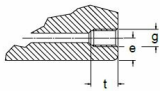
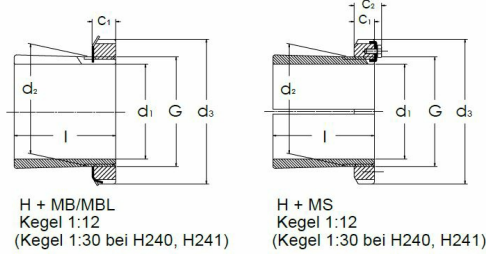

Technical data

| | |
|-------------|---------|
| d1 (mm) | 160 |
| d2 (mm) | 180 |
| l (mm) | 109 |
| d3 (mm) | 210 |
| G | M 180X3 |
| c1 (mm) | 29.5 |
| c2 (mm) | - |
| g | M 6 |
| e (mm) | 4.2 |
| t (mm) | 9 |
| Weight (kg) | 6.83 |

Related products

KML 36
Locknuts with metric threads

MBL 36
Locking washers with metric dimensions