

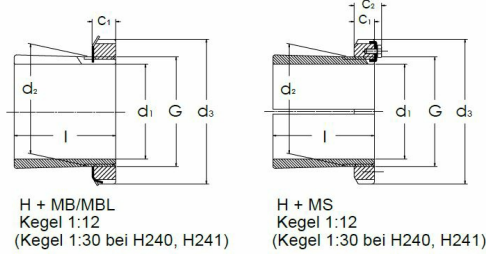

H 315

Adapter sleeves with metric dimensions



Technical data

d1 (mm)	65
d2 (mm)	75
l (mm)	55
d3 (mm)	98
G	M 75x2
c1 (mm)	15
c2 (mm)	-
g	-
e (mm)	-
t (mm)	-
Weight (kg)	0.83

GTIN/EAN



Related products

KM 15
Locknuts with metric threads

MB 15
Locking washers with metric dimensions