

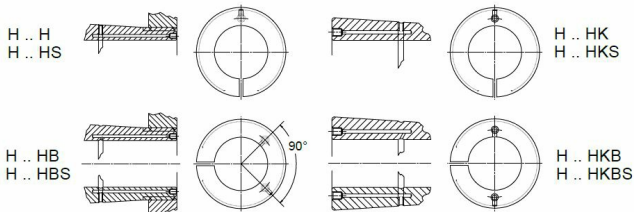

# H 207

Adapter sleeves with metric dimensions

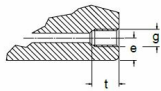
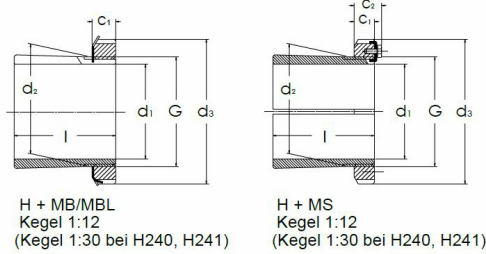

## Technical data

d1 (mm)	30
d2 (mm)	35
l (mm)	29
d3 (mm)	52
G	M 35x1,5
c1 (mm)	9
c2 (mm)	-
g	-
e (mm)	-
t (mm)	-
Weight (kg)	0.13

GTIN/EAN



## Related products

KM 7  
Locknuts with metric threads

MB 7  
Locking washers with metric dimensions