

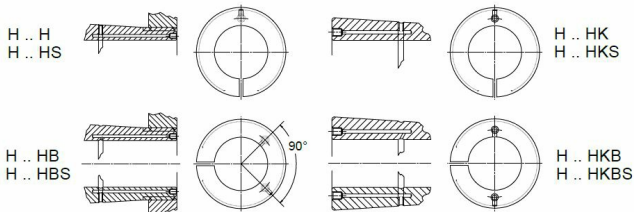

# H 205

Adapter sleeves with metric dimensions

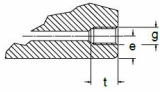
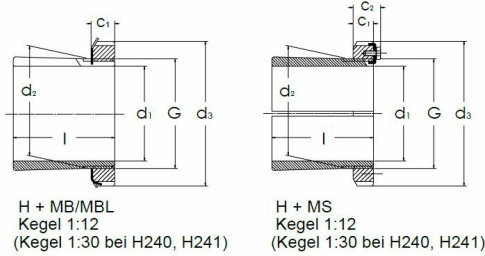

## Technical data

d1 (mm)	20
d2 (mm)	25
l (mm)	26
d3 (mm)	38
G	M 25x1,5
c1 (mm)	8
c2 (mm)	-
g	-
e (mm)	-
t (mm)	-
Weight (kg)	0.07

GTIN/EAN



## Related products

KM 5  
Locknuts with metric threads

MB 5  
Locking washers with metric dimensions