

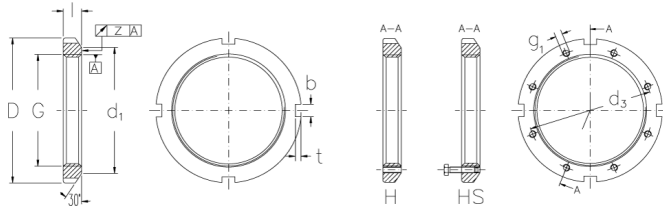

# KML 36 HS

Locknuts with metric threads



## Technical data

G	M 180x3
l (mm)	27
D (mm)	210
d1 (mm)	200
b (mm)	16
t (mm)	5
z (mm)	0.06
g1	M8
d3 (mm)	194
Weight (kg)	2.02

## Related products

MB 36 H  
Mounting washers

MBL 36  
Locking washers with metric dimensions