

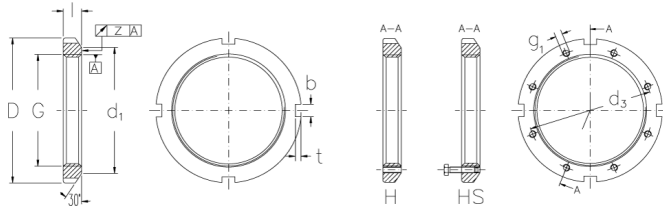

KML 32 HS

Locknuts with metric threads



Technical data

G	M 160x3
l (mm)	25
D (mm)	190
d1 (mm)	189
b (mm)	14
t (mm)	5
z (mm)	0.06
g1	M8
d3 (mm)	174
Weight (kg)	1.64

Related products

MB 32 H
Mounting washers

MBL 32
Locking washers with metric dimensions