

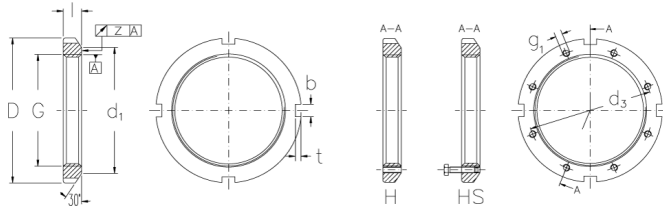

# KM 28 HS

Locknuts with metric threads



## Technical data

G	M 140x2
l (mm)	22
D (mm)	180
d1 (mm)	160
b (mm)	14
t (mm)	6
z (mm)	0.06
g1	M8
d3 (mm)	154
Weight (kg)	1.64

## Related products

MB 28  
Locking washers with metric dimensions