

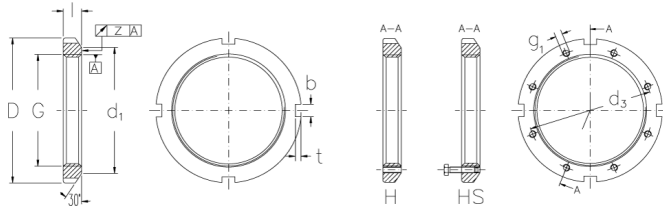

KM 22 HS

Locknuts with metric threads



Technical data

G	M 110x2
l (mm)	19
D (mm)	145
d1 (mm)	133
b (mm)	12
t (mm)	5
z (mm)	0.05
g1	M6
d3 (mm)	122
Weight (kg)	1.01

Related products

MB 22
Locking washers with metric dimensions