

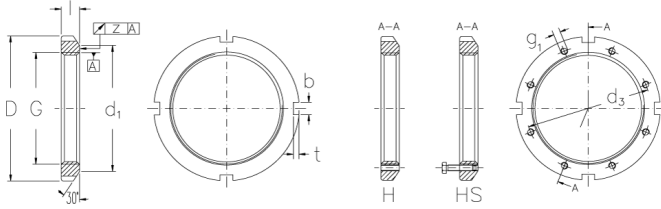

KM 12

Locknuts with metric threads



Technical data

G	M 60x2
l (mm)	11
D (mm)	80
d1 (mm)	73
b (mm)	7
t (mm)	3
z (mm)	0.05
g1	-
d3 (mm)	-
Weight (kg)	0.17

GTIN/EAN



Related products

MB 12
Locking washers with metric dimensions