

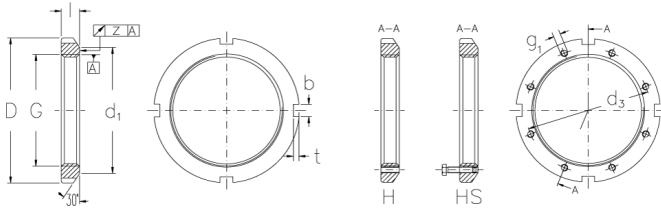

KM 10

Locknuts with metric threads



Technical data

G	M 50x1,5
l (mm)	11
D (mm)	70
d1 (mm)	61
b (mm)	6
t (mm)	2.5
z (mm)	0.04
g1	-
d3 (mm)	-
Weight (kg)	0.15

GTIN/EAN



Related products

MB 10
Locking washers with metric dimensions