

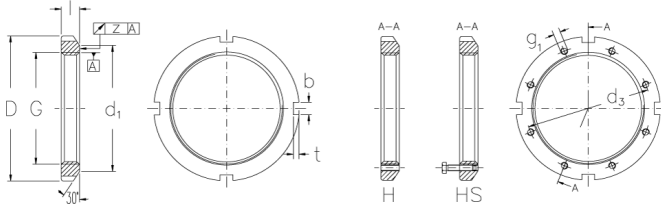

# KM 8

Locknuts with metric threads



## Technical data

G	M 40x1,5
l (mm)	9
D (mm)	58
d1 (mm)	50
b (mm)	6
t (mm)	2.5
z (mm)	0.04
g1	-
d3 (mm)	-
Weight (kg)	0.09

## Related products

MB 8  
Locking washers with metric dimensions