

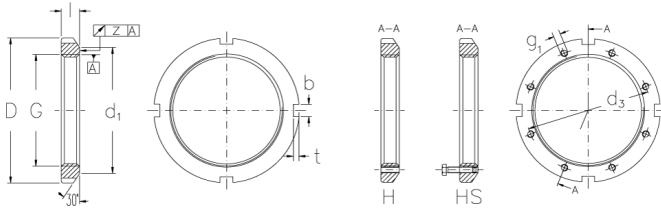

KM 1

Locknuts with metric threads



Technical data

G	M 12x1
l (mm)	4
D (mm)	22
d1 (mm)	17
b (mm)	3
t (mm)	2
z (mm)	0.04
g1	-
d3 (mm)	-
Weight (kg)	0.01

Related products

MB 1
Locking washers with metric dimensions