

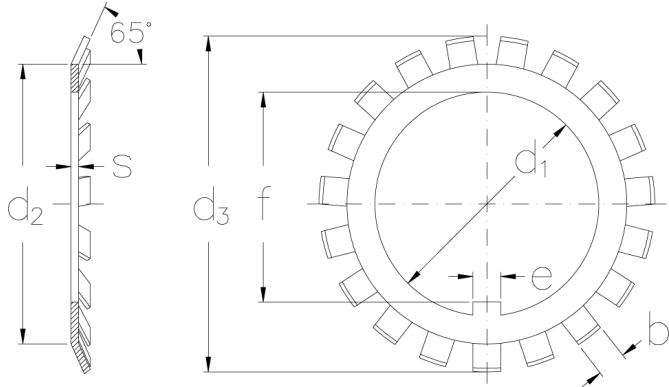

MB 11

Locking washers with metric dimensions



Technical data

d1 (mm)	55
d2 (mm)	67
d3 (mm)	81
s (mm)	1.5
e (mm)	8
b (mm)	7
f (mm)	52.5
Weight (kg)	0.022

GTIN/EAN



Related products

KM 11
Locknuts with metric threads