

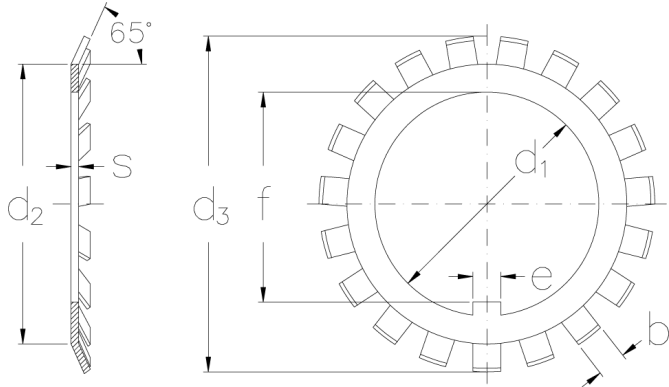

## MB 10

Locking washers with metric dimensions



### Technical data

d1 (mm)	50
d2 (mm)	61
d3 (mm)	74
s (mm)	1.25
e (mm)	6
b (mm)	6
f (mm)	47.5
Weight (kg)	0.016

GTIN/EAN



### Related products

KM 10  
Locknuts with metric threads