

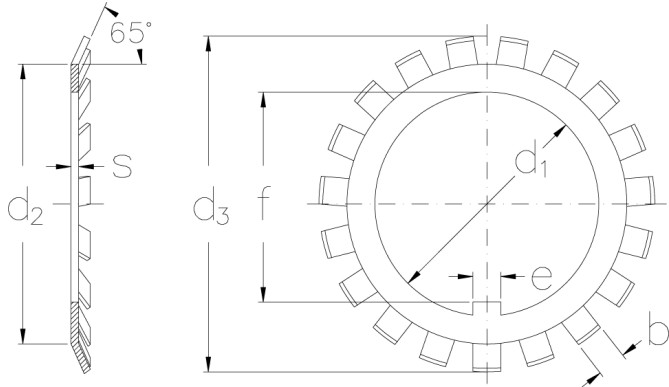

MB 6

Locking washers with metric dimensions



Technical data

d1 (mm)	30
d2 (mm)	38
d3 (mm)	49
s (mm)	1.25
e (mm)	5
b (mm)	5
f (mm)	27.5
Weight (kg)	0.008

GTIN/EAN



Related products

KM 6
Locknuts with metric threads