

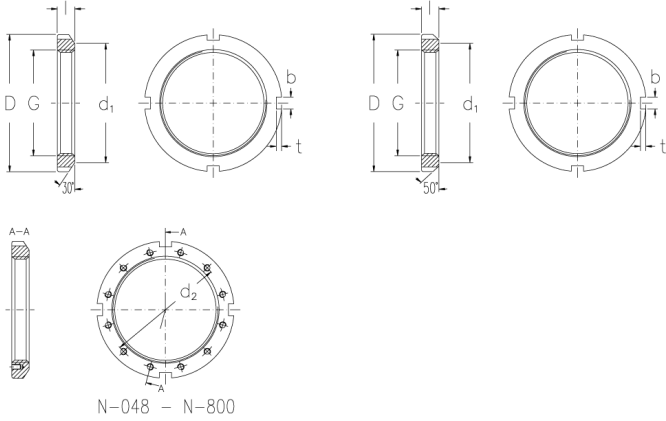

N-096

Locknuts with inch dimensions



Technical data

G (Inch)	18.894
Threads per inch	5
l (Inch)	2.385
D (Inch)	22.068
d1 (Inch)	20.75
b (Inch)	1.48
t (Inch)	0.604
d2 (Inch)	20.673
Weight (kg)	25.9
Screw	5/8 - 11-1 1/4

GTIN/EAN

