

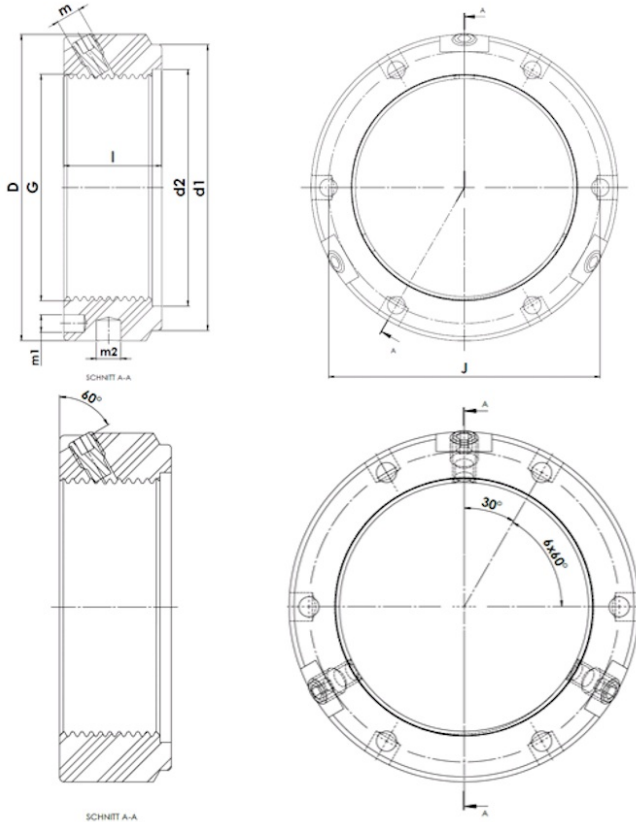

# KMTA 20

KMTA - Precision clamp nut, heavy duty, with three radial clamping pins



## Technical data

G	M100x2
l (mm)	32
D (mm)	130
d1 (mm)	120
d2 (mm)	103
J (mm)	118
m	M10
m1 (mm)	6
m2 (mm)	8
Weight (kg)	1.3