

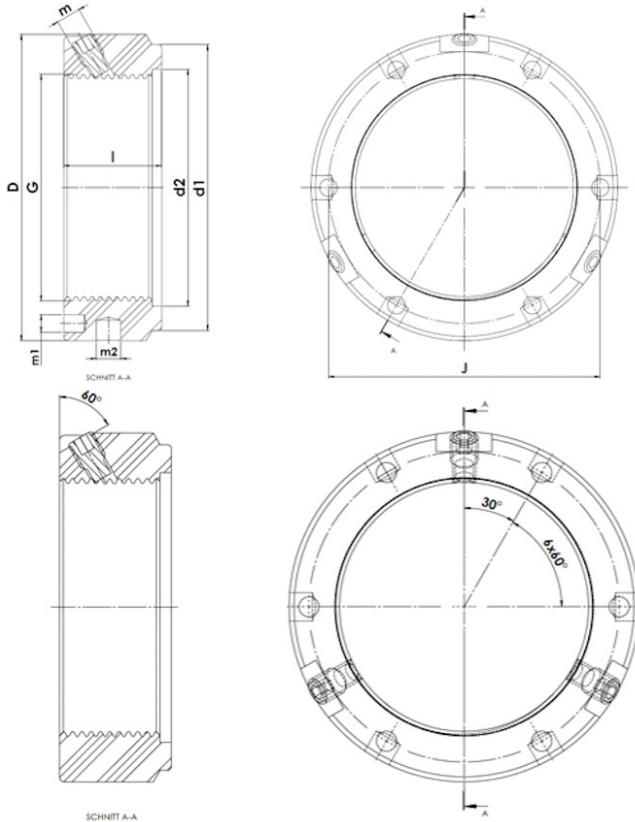

KMTA 13

KMTA - Precision clamp nut, heavy duty, with three radial clamping pins



Technical data

G	M65x1,5
l (mm)	25
D (mm)	88
d1 (mm)	80
d2 (mm)	68
J (mm)	78.5
m	M6
m1 (mm)	5
m2 (mm)	6
Weight (kg)	0.52