

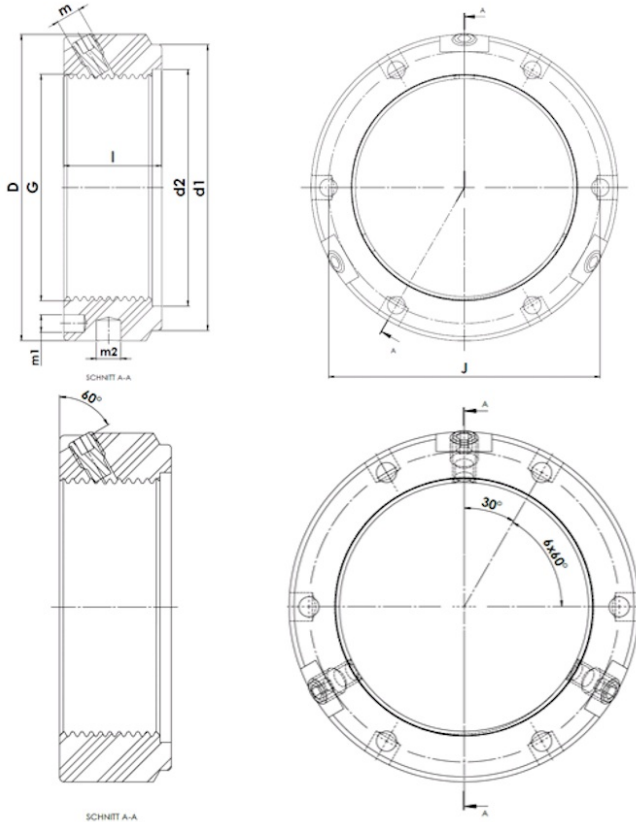

KMTA 8

KMTA - Precision clamp nut, heavy duty, with three radial clamping pins



Technical data

G	M40x1,5
l (mm)	22
D (mm)	58
d1 (mm)	52
d2 (mm)	42
J (mm)	50.5
m	M6
m1 (mm)	4
m2 (mm)	5
Weight (kg)	0.23