

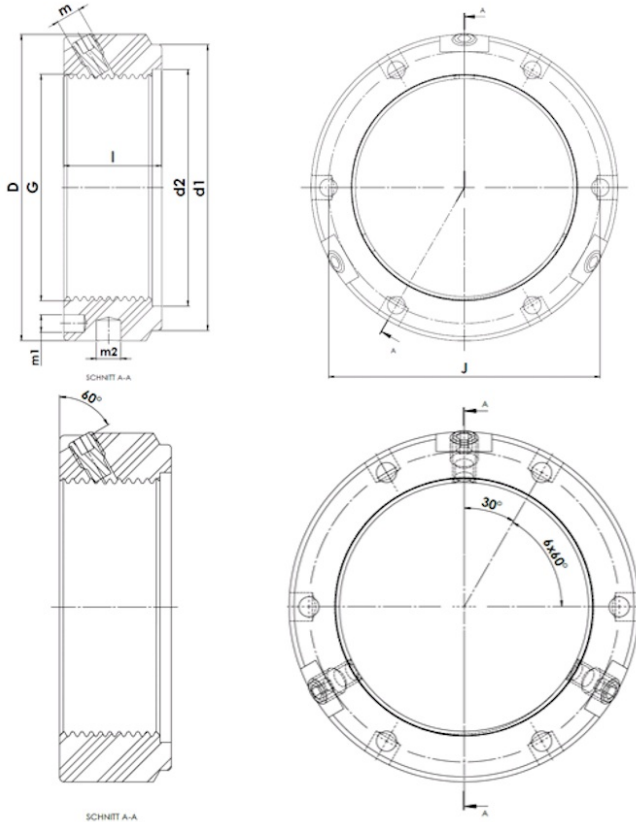

KMTA 6

KMTA - Precision clamp nut, heavy duty, with three radial clamping pins



Technical data

G	M30x1,5
l (mm)	20
D (mm)	48
d1 (mm)	40
d2 (mm)	32
J (mm)	40.5
m	M6
m1 (mm)	4
m2 (mm)	5
Weight (kg)	0.16

GTIN/EAN

