

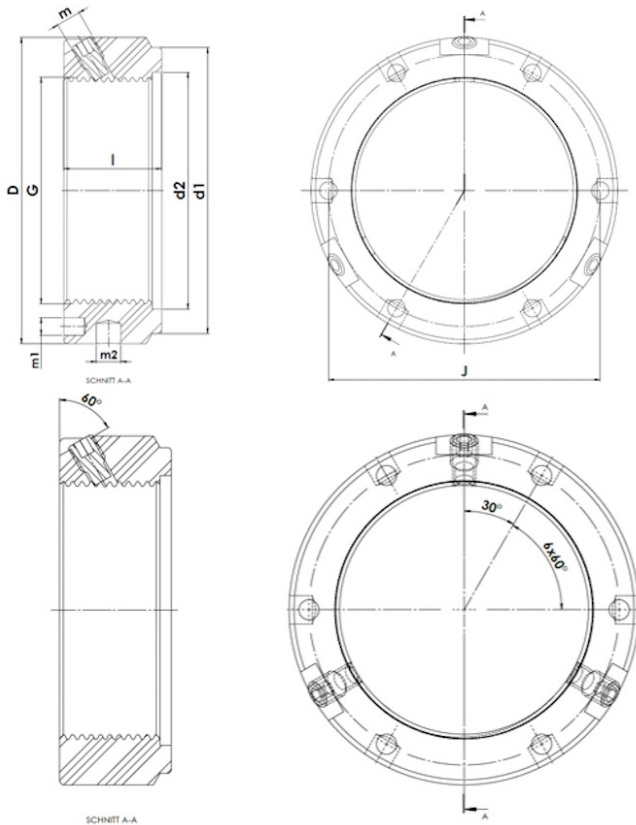

KMTA 5

KMTA - Precision clamp nut, heavy duty, with three radial clamping pins



Technical data

G	M25x1,5
l (mm)	20
D (mm)	42
d1 (mm)	35
d2 (mm)	26
J (mm)	32.5
m	M6
m1 (mm)	4
m2 (mm)	4
Weight (kg)	0.13

GTIN/EAN

